



## 1 Bedroom Flat for Rent

Saperton Walk, Lambeth, London, SE11 6NP



### Key Features

- VIRTUAL TOUR AVAILABLE • First Floor Flat • Spacious Reception • One Double Bedroom • Double Glazed Windows • Access to Shared Garden • Off Street Parking

£287 per week

## Description

A bright one bedroom first floor flat situated in Lambeth.

This fantastic flat comprises a spacious reception benefitting from wide double glazed windows allowing plenty of light. There is a fully fitted kitchen and a large double bedroom allowing plenty of storage space. There is a tiled shower room which features an electric shower.

The flat has access to it's own courtyard with a large shared garden space and benefits from off-street parking.









Saperton Walk, SE11

CAPTURE DATE 24/04/2021 LASER SCAN POINTS 1,100,558

GROSS INTERNAL AREA

48.53 sqm / 522.37 sqft

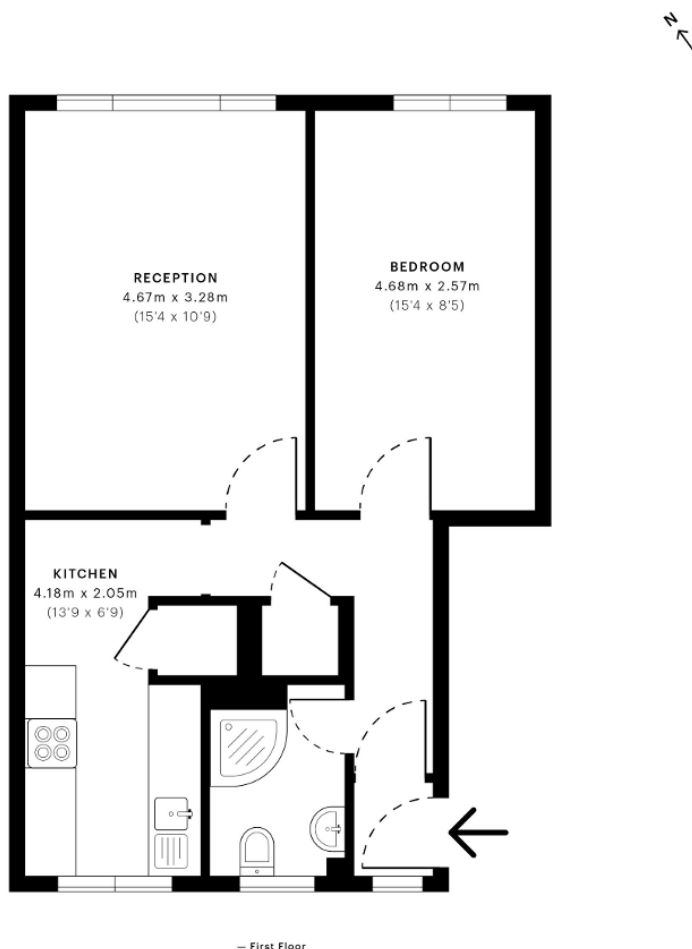

First Floor

**GROSS INTERNAL AREA (GIA)**  
The footprint of the property  
48.53 sqm / 522.37 sqft

**NET INTERNAL AREA (NIA)**  
Excludes walls and external features  
Includes walkways, restricted head height  
45.29 sqm / 487.50 sqft

**EXTERNAL STRUCTURAL FEATURES**  
Balconies, terraces, verandas etc.  
0.00 sqm / 0.00 sqft

**RESTRICTED HEAD HEIGHT**  
Limited use area under 1.5 m  
0.00 sqm / 0.00 sqft



Spec Verified floor plans are produced in accordance with Royal Institution of Chartered Surveyors' Property Measurement Standards. Plots and gardens are illustrative only and excluded from all area calculations. Due to rounding, numbers may not add up precisely. All measurements shown for the individual room lengths and widths are the maximum points of measurements captured in the scan.

IPMS 3B RESIDENTIAL 48.92 sqm / 526.57 sqft  
IPMS 3C RESIDENTIAL 45.98 sqm / 494.92 sqft

SPEC ID: 608150bfca5b0f0dcd3caba1

**Disclaimer:** These particulars are thought to be materially correct though their accuracy is not guaranteed and they do not form part of any contract. All measurements are approximate and we have not tested any fitted appliances, electrical or plumbing installation or central heating systems.